



# **Avaya 3910 Wireless Telephone**

## **Installation Guidelines**

15-300249  
Comcode 700343015  
Issue 1  
November 2004



# Installation Guidelines

---

## Overview

This document provides general guidelines for installing the Avaya 3910 Wireless Telephones. Following these guidelines will help ensure satisfactory performance of the Avaya 3910 Wireless Telephones.

Before installing the Avaya 3910 Wireless Telephones, keep in mind the following information:

- If possible, place the base unit in a centralized location relative to the locations where the Avaya 3910 Wireless Telephone will be used.
- Install the base unit as high as possible so that it clears nearby objects (for example, office cubicles and file cabinets).
- More than three base units in a confined area will degrade product performance. Refer to [“Determining the Location for the Base Units” on page 3](#) to optimize locations of up to 10 base units in a building or desired coverage area.
- Each Avaya 3910 Wireless Telephone requires its own base unit.

If you have three or fewer Avaya 3910 Wireless Telephones, place all of the base units in a centralized location and at least five feet apart. (See [Figure 1](#).)

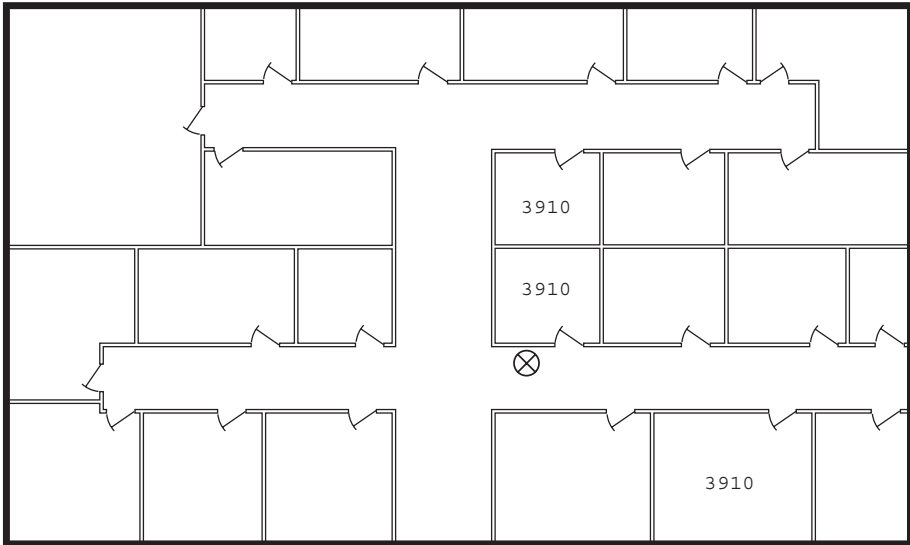
**Figure 1: Configuration with Three Avaya 3910 Wireless Telephones**

⊗ Location of Base Units

If you have more than three Avaya 3910 Wireless Telephones, go to [“Determining the Location for the Base Units” on page 3.](#)

---

## Determining the Location for the Base Units

To obtain the best possible performance from the Avaya 3910 Wireless Telephones, you must install all of the base units in a location that will provide proper coverage. To determine the location for the base units, perform the following steps:

- 1 Draw a floor plan of your building. [Figure 2](#) shows the floor plan for a sample company.

**Figure 2: Floor Plan for a Sample Company**

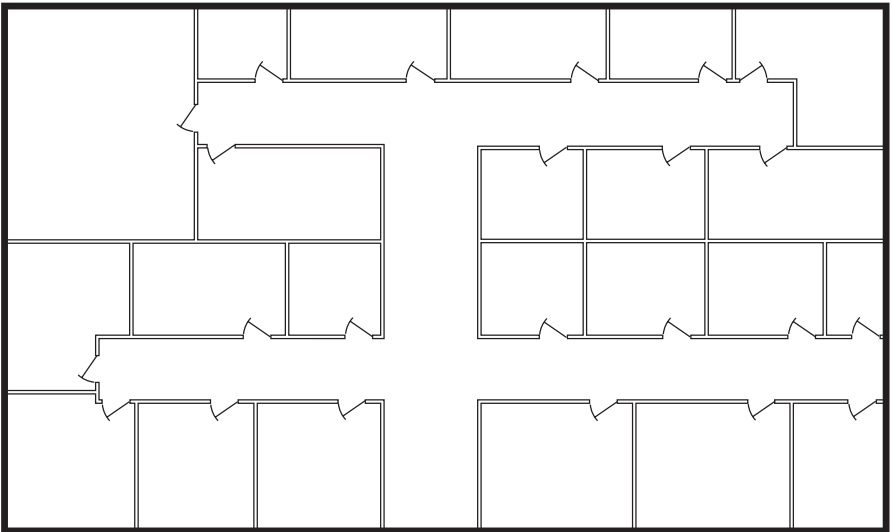

- 2 Identify all of the people in your company who will use an Avaya 3910 Wireless Telephone.

- 3 On your floor plan, identify all areas (for example, offices, conference rooms, and lobbies) where you expect the Avaya 3910 Wireless Telephones to be used. (See [Figure 3](#).)
- 4 On your floor plan, identify the location where you want to install all of the base units for the Avaya 3910 Wireless Telephones (for example, a hallway).

[Figure 3](#) shows the completed floor plan and base unit location for the sample company.

**Figure 3: Location of Base Units for a Sample Company**

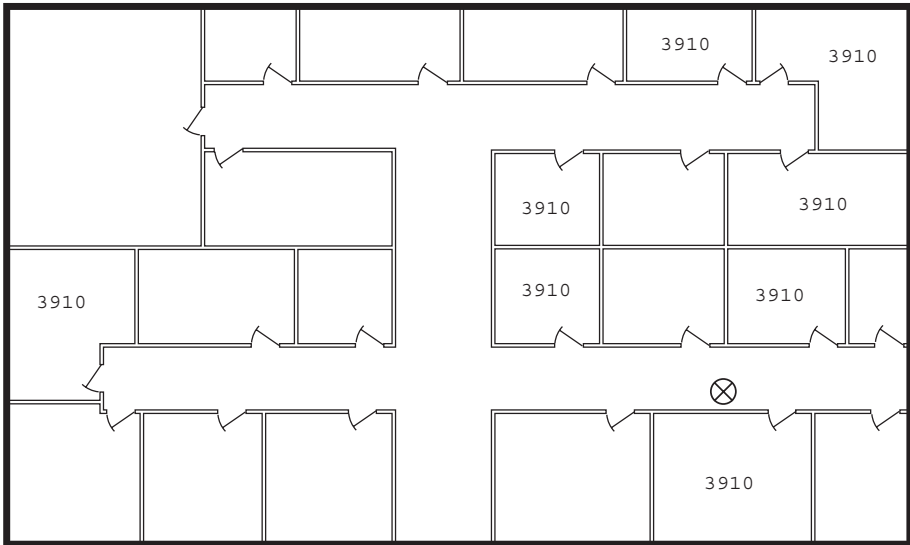

⊗ Location of Base Units

- Using the base unit location as the center, draw a circle with a 160 foot radius. This circle indicates the coverage area of all of the base units.

Figure 4 shows the coverage area for the sample company.

**Figure 4: Coverage Area of the Base Units**

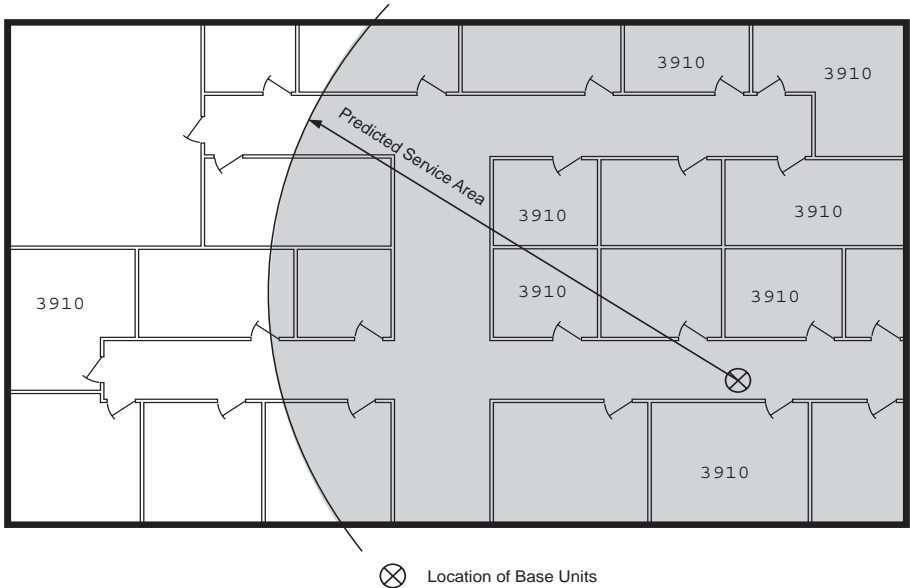

- Verify whether the circle encompasses all of the areas where the Avaya 3910 Wireless Telephones will be used.

**7** Perform one of the following steps:

- If the circle encompasses all of the areas where the Avaya 3910 Wireless Telephones will be used, go to Step 9.
- If the circle does not encompass all of the areas where the Avaya 3910 Wireless Telephones will be used, perform one of the following steps:
  - Select a location for all of the base units that is “centrally located” within the area where the Avaya 3910 Wireless Telephones will be used. (This new location should encompass all of the areas where the Avaya 3910 Wireless Telephones will be used.)
  - Identify a base unit location for the Avaya 3910 Wireless Telephones that are not covered by the current base unit location. Draw a circle with a 160 radius around this second base unit location, and verify that the circle encompasses those Avaya 3910 Wireless Telephones that were not covered by the first base unit location.

[Figure 5](#) shows multiple locations of base units for a sample company.

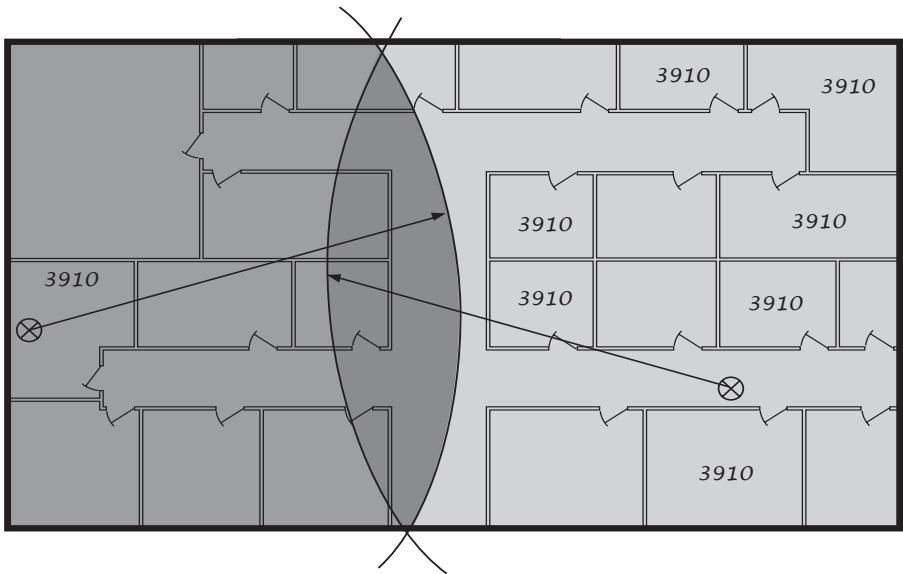
**Figure 5: Multiple Locations for Base Units**

Location of Base Units

- 8 Repeat Step 7 until all of the Avaya 3910 Wireless Telephones are included in an area covered by the base units.

- 9** After all of the Avaya 3910 Wireless Telephones are covered on your floor plan, perform one of the following steps:
- If you have one to three base units, install each base unit at least five feet apart in the selected location. Be sure to install each base unit as high as possible so it clears nearby objects (for example, office cubicles and file cabinets). This grouping of base units is referred to as a *cluster*.
  - If you have four or more base units:
    - a** Install three of the base units in the selected location, with each base unit being five feet away from another base unit. Be sure to install each base unit as high as possible so it clears nearby objects (for example, office cubicles and file cabinets). This grouping of base units is referred to as a *cluster*.
    - b** Select a location that is at least 30 feet away from the cluster, and install another cluster of up to three base units. Within this new cluster, make sure each base unit is five feet away from another base unit. Be sure to install each base unit as high as possible so it clears nearby objects (for example, office cubicles and file cabinets).
    - c** Repeat Step b until all of the base units are installed.

When you are finished determining the location for the base units, install the base units and perform a test call from each handset. Be sure to walk to all areas where the handset will be used so you can determine whether the voice quality is acceptable.